

NEW MODEL NOW OPEN

HIDDEN MEADOWS

ADULT COMMUNITY

LUXURIOUS HOMES
DESIGNED FOR YOUR LATER
YEARS IN LIFE

FLORIDA-STYLE LIVING (FOR 55 YRS. OR OLDER).
TOP OF LINE MANUFACTURED HOMES.
SECLUDED & PRIVATE. MANY FLOOR PLANS
AVAILABLE. PROFESSIONALLY LANDSCAPED,
DECKS, LARGE LOTS, LIGHTING. MONTHLY FEE
INCLUDES: WATER, SEWER, PROPERTY TAXES,
SNOW PLOWING OF MAIN ROADS THRU
COMMUNITY & TOTAL LAWN CARE.

OPEN FOR INSPECTION SUNDAYS
1 PM-4PM (OR SHOWN BY APPT.)

CALL: 494-1424

7289 LAKE RD. BERGEN, NY 14416
1 Mile South of Rte. 33 & 19



GYP SUM MILLS

ESTATES

Rochester Area's First Planned Community for Double Wide & Mobile Homes

OPEN HOUSE



- Senior Citizen, Adult and Family Sectors
- 2-Story Clubhouse with Restaurant, Auditorium and Planned Activities
- Victor Schools
- Tennis, Fishing, Skiing & Ice Skating
- 9-Hole Golf Course Now Under Construction

12 HOMES ON DISPLAY
Starting at \$34,969.20

SALES BY:
Victor Estate Homes 924-4710
and
Better Living Homes 924-9900
Open 7 Days a Week
Plasterville Road, Victor, NY

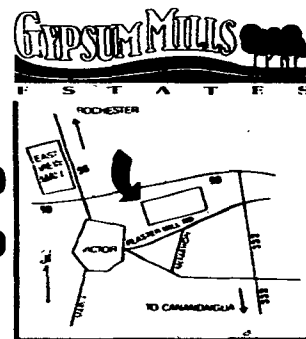

THE ADDRESS OF DISTINCTION

1600 ELMWOOD



Quiet elegance in suburban Brighton where Elmwood and Clinton Avenues join. Rental for these superbly located, spacious apartments with balconies includes light, heat, water, and central air conditioning. Full-color brochure available.

1600 Elmwood Avenue Apartments
Rochester, New York 14620 - (716) 473-2544
Visit weekdays 9 - 4:30 or by appointment
Professionally managed by Home Leasing Corporation



POPULAR EUROPEAN STYLE PLAN FEATURES ORNATE EXTERIOR TRIM

By W.D. FARMER, A.L.R.
A formal entrance foyer allows excellent passage to the formal living or dining room as well as to the spacious family room to the rear. The family room is shown with a fireplace at the end of the home and allows entrance to the basement or the rear sun deck. The kitchen is close by and cabinets are in abundance. A spacious breakfast room is shown, also with access to the sun deck, as well as the double garage and the separate laundry room. A central half bath is included for daytime convenience on the first floor. There are three bedrooms upstairs, all with excellent closet space, the master bedroom having access to the luxury bath with separate shower and commode area. The bonus room also may be finished as a bedroom either during construction or later by the household handyman. The exterior style is constructed of stucco and the windows are multi-lite accented by wood panels between. Corner quoins are added to enhance the beauty of this plan and a dormer window is shown for extra light to the bonus room. This is a computer generated plan. The plan is Number 2550. It includes 2,586 square feet of heated area. All W.D. Farmer plans include construction details for energy efficiency and are drawn to meet FHA and VA requirements. For further information write to W.D. Farmer, P.O. Box 450025, Atlanta, GA 30345.

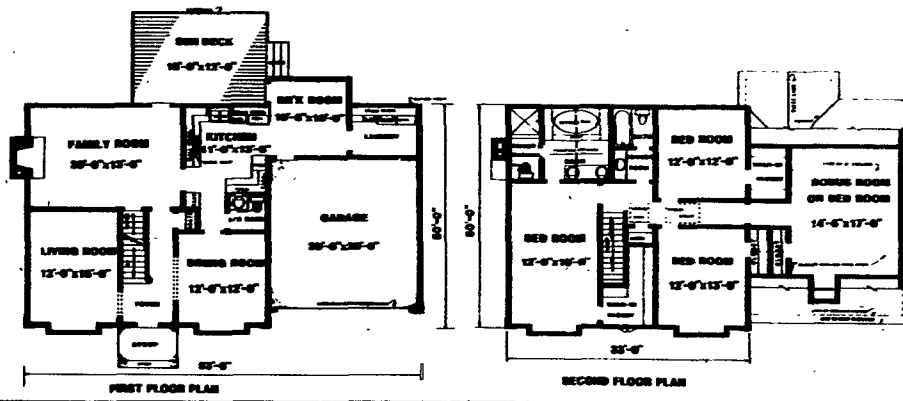

To advertise in the Catholic Courier's new Real Estate section, call (716)328-4340.