



HIDDEN MEADOWS

ADULT COMMUNITY

LUXURIOUS HOMES
DESIGNED FOR YOUR LATER
YEARS IN LIFE

FLORIDA-STYLE LIVING (FOR 55 YRS. OR OLDER).
TOP OF LINE MANUFACTURED HOMES.
SECLUDED & PRIVATE. MANY FLOOR PLANS
AVAILABLE. PROFESSIONALLY LANDSCAPED,
DECKS, LARGE LOTS, LIGHTING. MONTHLY FEE
INCLUDES: WATER, SEWER, PROPERTY TAXES,
SNOW PLOWING OF MAIN ROADS THRU
COMMUNITY & TOTAL LAWN CARE.

OPEN FOR INSPECTION SUNDAYS
1 PM-4PM (OR SHOWN BY APPT.)

CALL: 494-1424

7289 LAKE RD. BERGEN, NY 14416
1 Mile South of Rts. 33 & 19

Better Living Homes

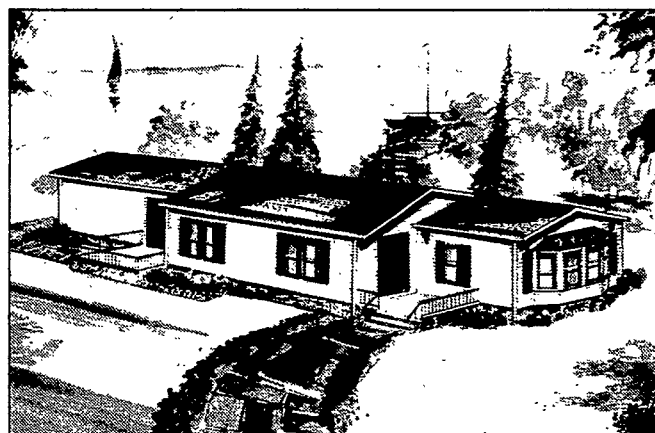

Is Having a Display Model Sale!

Better Living Homes is one of Western NY's leading manufactured housing retailers since 1956.

- Featuring top quality homes by Ritz-Craft and Victorian (built with 2X6's).
- Mobile Homes, Double-wides, and Modular Homes.

Right now, save thousands on Display Models!

Visit Better Living Homes, on Rt. 15, 4 miles south of exit 11, 390 South. Open 7 days a week.

(716)533-1050



Wrap-around Porch Offers Shady Relaxation

MOULDINGS AND TRIM EMBELLISH A COUNTRY VICTORIAN PLAN

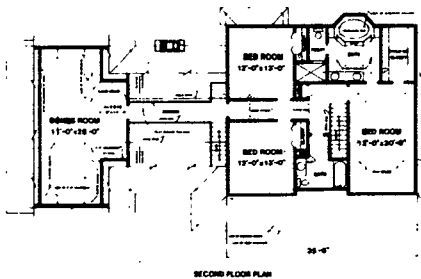
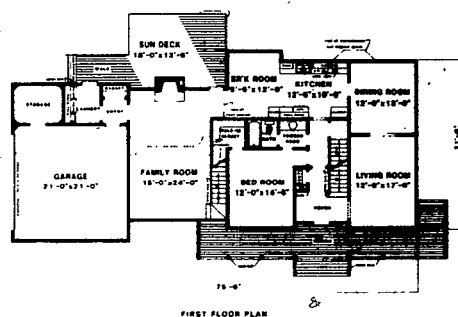

By W.D. FARMER, A.I.S.D.
A second set of stairs can offer access to a possible fifth bedroom in this design and double as a privacy stair to entire second floor. Poyer stairs are shown for the main entry and basement stairs are neatly tucked below.

Formal and informal rooms are all provided separately throughout and the master bedroom suite boasts a tray ceiling and spacious private compartment bath. The bonus room will accommodate a multitude of purposes and the family room is larger. A garage entry is shown with a coat closet and the laundry is shown with rear access.

The formal living room and dining room are isolated from daily traffic punishment but provide a convenient layout for formal entertaining. A central bath services the first floor and the convalescence or guest room.

The exterior is characteristic of a bygone era with trim and roof design of those times. This is a computer plan. Some changes may be made from the plan stored in the CADD memory at less cost to you. Direct inquiries about CADD plan changes to the address below.

The plan is number 3219. It includes 3,238 square feet of heated area. The plan is drawn to include a basement. All W.D. Farmer plans include special construction details for energy efficiency and are drawn to meet FHA and VA requirements. For further information write, W.D. Farmer, P.O. Box 450025, Atlanta, GA 30345.

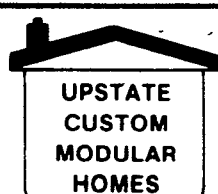

WE inc.
MODEL at
118 Rte. 104
Ontario, NY



716-265-3437

Today's Modular Home is a standard built home built in a controlled environment and custom designed to your exact needs and gives you more for your dollar.

WE OFFER (3) BUILDING PLANS

- (1) COMPLETE TURN-KEY (We do all the work)
- (2) PARTIAL TURN-KEY (You do some of the work to save)
- (3) BUILDER (You do more of the work to save more)

COMMUNITIES PRESENTLY AVAILABLE:

MYSTIC MEADOWS-Located in the Ontario/Williamson area near Lake Ontario. Homes starting at \$68,900. On nice country lot.
ROSELL ESTATES-Located in Webster, has large wooded sites with homes starting at \$119,000.
Farmette size sites nearing final approval in Walworth and Ontario.

We can assist you in finding that special site or selling your present home through our multiple listing service by:

SPENCER R. STREMICZ REALTORS
64 North Main Street, Brockport, N.Y. 14420
716-637-0770

Modulars are the homes of the future. Let us show you why.

Contempri HOMES
Exciting Innovations in Housing

To advertise in the Catholic Courier's new Real Estate section, call (716)328-4340.