

ADVERTISEMENT: This entire page is a paid advertisement.

Published by the Rochester Gas & Electric Corp.

February 20, 1974

# RG&E consumer news



## Facts About Space Heaters

By Miss Anne S. Fenstermacher  
Staff Assistant-Consumer Affairs

I understand that some of RG&E's customers are using portable space heaters in some rooms in order to adapt to the current energy situation. I want to repeat some facts from a previous article about electric heaters, and add some facts about portable gas heaters because there are important precautions to take with their use.

The average wattage of an electric space heater is 1,000-1,500 watts, which means it draws a considerable amount of electricity and can be expensive to operate over a long period of time.

A radiant-type heater may be placed on a carpet but should have several inches of space around all sides to allow for proper air circulation. Keep any combustible material far away from it.

A heavy-duty extension cord should be used if the heater's cord is not long enough to reach the outlet. Never use a light-duty extension cord with a space heater because it was meant for use with lamps and is not heavy enough to use safely with a space heater.

The heater should have a "tipover" switch so it will shut off if it is accidentally

knocked over. It should also have the U.L. Seal of Approval indicating that it has been inspected for safety by the Underwriters Laboratory.

If you blow a fuse when you plug the heater in, your wiring may not be adequate. Call an electrician or RG&E's Residential Department at 546-2700, Extension 2751.

It is illegal to sell, service or install unvented gas space heaters in New York State. The heater must be vented to the outside for safe use. The products of combustion, may contain carbon dioxide, a lethal gas. Also, gas cooking ovens should not be used for spaceheating. They are not designed for such service and with all the house windows closed and the oven on for a long time, the oxygen in the room could be used up and carbon monoxide could be formed.

## Insulating your home: Part I

### Insulation Conserves Heating Energy

Heating is the single greatest use of energy in your home. If you can reduce the amount of energy you use for heating, you will conserve energy, and keep your energy costs reasonable. During the next few weeks we'd like to tell you all about insulating your home.

Insulation is the best way to reduce the amount of energy you use to heat and cool your home. A properly insulated home will use up to 50% less energy than a home with no insulation, and up to 25% less than an inadequately insulated house.

Rising fuel costs have made greater amounts of insulation more economically sound than in the past so a home insulated to accepted standards fifteen years ago will be underinsulated by today's standards.

What is insulation? Insulation is a material that is resistant to heat flow. It is used wherever the flow of heat needs to be halted.

Refrigerators are insulated. Ovens are insulated. Homes should be.

Insulation may be made of any one of a number of materials. Since different materials have different resistance to heat flow, even though they may be the same thickness, a common scale of "R" values was devised. The "R" value tells you how resistant to heat flow a

## "How to Survive as a Consumer" at Consumer Center rest of week

For the past two weeks the RG&E Consumer Information Center has been the headquarters for learning the art of being a consumer. If you haven't stopped in to see the current display at the Consumer Information

Center, plan to do so during the rest of this week. The Center is in our main office, 89 East Ave.

By visiting the Center, you will learn about some of the problems the consumer faces, what is

being done about the problems and what you, as the consumer, can do to help yourself. You will learn how to use consumer legislation, consumer organizations and consumer aides to your benefit.

For instance, did you know the Truth in Packaging Law requires that each item in a list of ingredients on a product appears in order of predominance? With this information you can better compare two or more brands of the same product.

And have you ever heard of the Consumer Arbitration Program, a vehicle for resolving disputes between a business and a consumer? Or how about MACAP, the Major Appliance Consumer Action Panel? You'll find free literature about MACAP at the Center, as well as a leaflet, "Helps for the Consumer," on several organizations at the local, state, and national level which have been set up for your benefit.

The Consumer Information Center will tell you about many consumer aides you can use when you shop, such as unit pricing and open dating. You will learn what is being done to help you in appliance stores, such as improved warranty protection and more detailed information labels on appliances.

Visit the Consumer Information Center next week to learn how you can survive as a consumer. If you have a special question, a member of the Home Service Department will be glad to help you.



Use the information tags on appliances to help with your purchase choice.

given material is at a given thickness. The higher the "R" value, the greater the resistance, and the effectiveness of 2" of a material with a high "R" value may equal that of 4" of a less resistant material.

Recommended "R" values for homes today are R-19 in ceilings under cold attics, and R-11 in walls exposed to the outdoors or unheated areas. The drawing here shows where a home should be insulated.

Often it is economical to reinsulate existing homes. This is particularly true where more insulation can be added in the attic.

Sometimes it is desirable to add insulation to the sidewalls, also. We'll cover that in a later part of this series.

Storm windows and doors are a form of insulation, and an important one, too. As much as 30% of the heat that escapes from your home does so through glass and through cracks around doors and windows. We'll talk about that in a later chapter, also.

You can learn a lot about insulation at our insulation display. It will be in Midtown Plaza February 21 through 28. Drop by and talk to our representatives.

Next week we'll start talking about types of insulation, what they are made of, how to install them, and their relative merits.

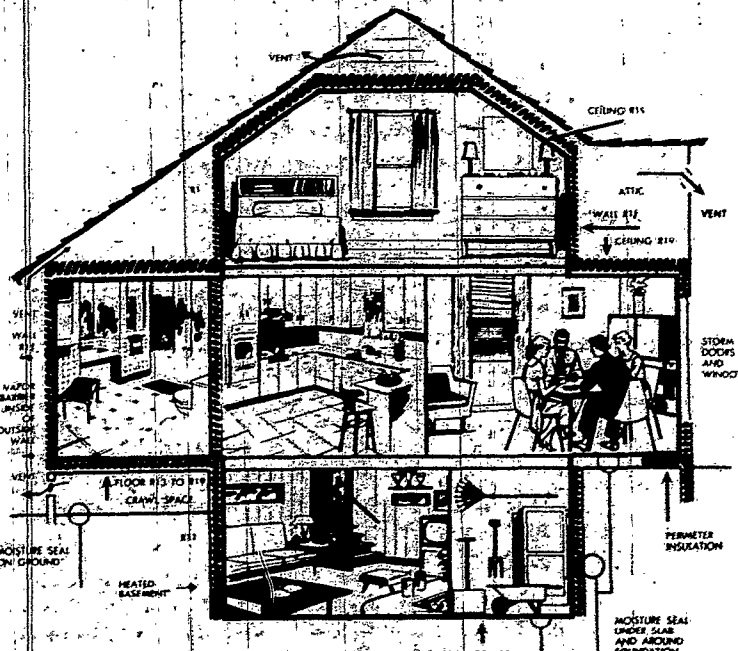

FILL OUT AND RETURN THIS COUPON TO:

CJ-1

Dept. 34 Rochester Gas and Electric  
89 East Avenue, Rochester, N.Y. 14649

I would like more information on the following items:

Name \_\_\_\_\_ Phone \_\_\_\_\_

Address \_\_\_\_\_ Zip Code \_\_\_\_\_