

# BETTER HOUSING

## FHA Has Given Impetus To U.S. Home Life

WASHINGTON, D. C.—The Federal Housing Administration has given impetus to the home life of the nation by its program operating at high speed to meet the pressing need for housing accommodations for the nation's growing population. The Federal Housing Administration, Federal Housing Administrator A. M. Ferguson, announced today.

Since June 27, 1934, when the Federal Housing Administration was created, the FHA program has approved for construction approximately 1,000,000 new homes. Through the FHA program, more than 1,000,000 homes have been built, and more than 1,000,000 families have been housed. The FHA program has also helped to build more than 1,000,000 homes, and more than 1,000,000 families have been housed.

## BACK TO NATURE



An answer comes, too, to the desire for better living conditions. All rooms have good ventilation, and the really large porch makes an outdoor dining room ideal for the sweltering hot months. It is simple and inexpensive in build, however, being a simple design. As a matter of fact, you can build it yourself, if you are handy with tools. That's a thought for the National Light Manufacturers Association, 1337 Connecticut Avenue, Washington, D. C., remodeling Design files for parties.

*[Please mention the Catholic Courier when writing for details.]*

## Needs Should Govern Living Room Size

The living room, as a meeting place of the family, should be the largest room in the house, according to the Federal Housing Administration.

Living-room sizes vary with the size of the house, the site and needs of the family, and the contemplated use of the room.

If the living room is intended for more than one use, its size should be enlarged to accommodate additional functions and furniture. A living-dining room, for example, should provide added space for tables and chairs, so placed that this additional furniture will not reduce the effective space of the living room.

When planning a living room, openings should be carefully studied, the FHA suggests. This is necessary to assure that sufficiently long and unbroken wall spaces may receive the larger pieces of furniture normally used. It is quite important that the living room be given a favorable location with respect to sunlight and attractive views, although not to the exclusion of favorable locations for other rooms.

Wherever the living room is located, FHA officials say, it should be comfortable and cheerful, with plenty of sunlight during the day. It should also be large enough to allow the various members of the family to use the room without any one person encroaching too much on the privacy or pursuits of the other members.

Many Uses

It often happens that the living room in small houses must serve the same purpose as the hall between the main entrance, kitchen, dining space, and the bedroom and bathroom area.

If possible, the living room should be entered through a small foyer, in which outer garments may be removed, and which acts as a buffer against direct intrusion into the living space. Where this is not possible, the entrance to the room should be at the end of the room opposite the windows.

The necessity of passing diagonally through the living room to reach other rooms of the house should be avoided.

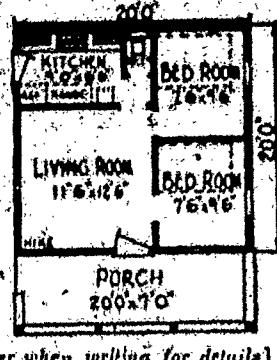

## Landscaping Service

### Care of Roses

In digging the holes in your Rose Beds before planting, remove one spad—depth of top-soil and pile it to one side of the hole. Make the hole wide enough and of sufficient depth to accommodate the roots without crowding.

Next, remove a second spad—depth. This is "sub-soil," and should not be replaced in the hole. The hole will now be about 18 in. deep. Then loosen and remove the dirt in the bottom of the hole and replace it with a shovel full of Top-soil, mixed with a liberal amount of fertilizer.

You are now ready to plant your Rose Bushes. First, prune the roots by shortening the long ones and cutting the ends of the short ones. Put the bush in the hole, spreading the roots out naturally. Work fine top-soil between the roots, packing it down little by little until the hole is three-quarters full. After tramping it down hard with your heels, pour in a pail of water. After the water is absorbed, fill the hole to normal level with good garden soil.

If you plant Roses in the Spring, prune all branches to about 6 to 8 inches above soil level. Only 2 or 3 "eyes" above ground level are necessary to furnish an abundance of bloom producing wood.

When planting in the Fall, Everblooming Roses should not be pruned until the following Spring just before growth starts.

Fertilizing. The first year no fertilizer of any kind should be applied, excepting that used in planting the Roses. After the first year, apply any good commercial fertilizer or manure if available. Do not apply fertilizer after Mid-Summer.

Watering. Flood the beds once a week placing the hose on the bed and letting it run by slowly so that the water reaches the roots. Roses like plenty to drink. Do not wet the foliage especially in the evening.

Pruning. Everblooming Roses should be pruned in the early Spring only, cutting back all branches to 6 to 8 inches above ground level. Do not prune during the blooming season as new blooms develop from the first top "eyes" under the previous cluster of blooms. Spruce blooms may be pinched frequently. Root pruning should not be shortened or reblooming will be stopped.

Cultivation. Do not allow the soil to bake or become hard. Cultivate the soil around the bushes and by regular cultivation, the air can reach them.

Our landscape consultant is always at your service to answer any questions you may have. There is no charge for this service. Write Catholic Courier Landscape Consultant or Phone Stone 1136.

## Warm Weather Is Sherbet Time

It's Sherbet time, so let's make good use of our patients' neglected and neglected fruit. First, let's make a "Plum Nectar" (Maraschino Sherbet) using a deliciously different combination of maraschino cherries—both fruit and juice—with a piquant plum nectar foundation. This Sherbet is a liquefied apricot, peaches and nectarines blended, pears, plums and peaches is all available in this "Sherbet" which is ready to help us with many summer frozen desserts.

**Plum Nectar Maraschino Sherbet**  
 1 1/2 cup plum nectar  
 1 1/2 cup granulated sugar  
 1 1/2 teaspoon salt  
 1 finely cut maraschino cherries  
 2 tablespoons maraschino cherry juice

**Ice Whites**  
 Combine nectar, lemon juice, sugar, salt, cherries and juice and stir to blend. Pour into an ice cream freezer (not necessary to remove paddles) and mix in stiffly beaten egg whites, turning frozen mixtures from sides of container. Close freezer and continue freezing. For variety, any of the whole-fruit nectars—apricot, peach, nectarine, pear or pineapple may be substituted for plum nectar in the same proportion.

Sufficient for a two-quart freezer.

A few Cook Books from the CATHOLIC COURIER'S "School of Cookery," Series I and II, are still available at the office of the CATHOLIC COURIER, 34 Chestnut St.

## Repairing Furniture

A simple method of repairing furniture that has split or cracked so that it looks "just like new" is available.

Obtain a scrap of lumber of the same species as the mated piece of furniture. Saw it until you have gathered a sufficient quantity of sawdust to fill the crack. Then take a water resistant glue and mix it with water until it forms a fine paste. To this, add the sawdust and stir until it blends with the paste to form a thick plastic dough. Carefully fill the crack with this substance, and allow it to harden. When it has set for a few hours it may be sanded and finished until it approximately matches the color of the furniture.

## Opposition To Summer Painting Declared Unsound By Experts

The five common objections to summer painting are being met by painting authorities, who declare that the opposition to warm-weather paint work is not based upon sound reasons.

The usual objections, painters say, are that people want painting done before insects make it necessary to put up screens, that shrubbery and flower beds are injured when a house is painted in Summer, that bugs stick to wet paint, that painting in Summer months is bad on "general principles," and that painters are a nuisance because they "block" the way.

In answering these objections, painters assert it is possible and practical to paint windows of a house without taking down all of the shrubbery and flower beds. They say that the screens in front of the windows can be removed

To meet the fear of injury to shrubbery and flowers, experts say the painter should be equipped with notched pegs and light manila rope with which to hold back plants. The painter should also have lightweight drop cloths for placing over small trees and shrubs.

Insects do stick to fresh paint, it is admitted, but bugs are a problem in the Fall as well, and the actual nuisance of bugs is of little consequence.

Painting in the direct rays of the Summer sun should be avoided, it is advised, but the work may be laid out to follow the movement of the sun.

A point advanced in favor of Summer painting is that it may be undertaken while the family is on vacation, thus avoiding the bother of fresh paint and other unpleasantness.

## Wise Equipment Choice Urged

The housewife who is planning to "go over" her kitchen this Summer on a limited budget should remember that if she plans wisely and buys carefully, all the efficiency and practically all of the beauty obtainable in the most expensive installations are within reach.

Modern basic appliances, refrigerator, sink, and range, are available in a wide variety of styles and colors. The new "low cost" line of "low cost" features.

Efficient design and sound sturdy construction are the more important considerations, according to the Federal Housing Administration.

Cabinets and counters are available in a wide variety of styles and colors. The new "low cost" line of "low cost" features.

It is important to note that many of the new "low cost" line of "low cost" features.

## Small Service Yard

The Federal Housing Administration has given impetus to the home life of the nation by its program operating at high speed to meet the pressing need for housing accommodations for the nation's growing population. The Federal Housing Administration, Federal Housing Administrator A. M. Ferguson, announced today.

Since June 27, 1934, when the Federal Housing Administration was created, the FHA program has approved for construction approximately 1,000,000 new homes. Through the FHA program, more than 1,000,000 homes have been built, and more than 1,000,000 families have been housed. The FHA program has also helped to build more than 1,000,000 homes, and more than 1,000,000 families have been housed.

## R. G. & E. Meeting All Power Demands of Local Defense Industries



### More Than 3 Times As Much Generating Capacity as Before Last War

More power for industry is the demand as Uncle Sam's defense program swings into high speed. And the business-operated electric utilities of the country, with a present installed power capacity greater than Germany, France, and England combined, are responding. Vital defense industries located in Rochester and surrounding area require an adequate and dependable supply of electric power. Here's how the R. G. & E. is meeting the situation.

Just before the outbreak of the World War in 1917 the R. G. & E. had a total installed capacity of about 53,000 kilowatts. When the newest 15,000-kilowatt turbine is put into service within the next three months the R. G. & E. capacity for generating electric power will be MORE THAN THREE TIMES as great as it was then. And that isn't all. An additional 25,000-kilowatt turbo-generator has been ordered and, when ready in early 1943, will increase installed capacity to well over 200,000 kilowatts. This capacity, insofar as anyone can foresee, will be adequate to care for all of Rochester's defense needs as well as normal demands of commercial and residential users. When present plans are completed less than 25 per cent of the total installed capacity will be water-power. All the rest can be produced through coal-burning steam plants, which are not affected by flow of river.

It is the policy of the R. G. & E. to have reserve capacity equal to the largest generating unit in the system. In other words it is so planned that the largest unit could be crippled and still not affect service to our customers.

## ★ Rochester Gas & Electric ★

**First Industrial Bank HAS JOINED Rochester Trust**

and beginning July 1st will be known and operated as **ROCHESTER TRUST'S**

**FIRST INDUSTRIAL BRANCH**

Through this acquisition of one of the city's oldest and largest personal loan banks, ROCHESTER TRUST'S facilities are broadened to include:

- ☐ Personal Loans for emergencies or opportunities, to pay bills and for other sound purposes.
- ☐ Business Loans to buy equipment or merchandise, discount bills, etc.
- ☐ Automobile Loans of all kinds
- ☐ Signature Loans for responsible individuals with assured incomes.
- ☐ Professional Loans and other types of credit.

Consultation and application for any of these services will be welcomed at either our Main Office or the First Industrial Branch, which continues in charge of Franklin W. Judson, assisted by the members of his experienced staff.

# Rochester Trust

SAFE DEPOSIT COMPANY — FOUNDED 1866

MAIN OFFICE: 30 CLINTON AVENUE NORTH  
 FIRST INDUSTRIAL BRANCH: 30 CLINTON AVENUE NORTH  
 MEMBER FEDERAL DEPOSIT INSURANCE CORPORATION

## Wise Equipment Choice Urged

The housewife who is planning to "go over" her kitchen this Summer on a limited budget should remember that if she plans wisely and buys carefully, all the efficiency and practically all of the beauty obtainable in the most expensive installations are within reach.

Modern basic appliances, refrigerator, sink, and range, are available in a wide variety of styles and colors. The new "low cost" line of "low cost" features.

Efficient design and sound sturdy construction are the more important considerations, according to the Federal Housing Administration.

Cabinets and counters are available in a wide variety of styles and colors. The new "low cost" line of "low cost" features.

It is important to note that many of the new "low cost" line of "low cost" features.

## Small Service Yard

The Federal Housing Administration has given impetus to the home life of the nation by its program operating at high speed to meet the pressing need for housing accommodations for the nation's growing population. The Federal Housing Administration, Federal Housing Administrator A. M. Ferguson, announced today.

Since June 27, 1934, when the Federal Housing Administration was created, the FHA program has approved for construction approximately 1,000,000 new homes. Through the FHA program, more than 1,000,000 homes have been built, and more than 1,000,000 families have been housed. The FHA program has also helped to build more than 1,000,000 homes, and more than 1,000,000 families have been housed.

## Wise Equipment Choice Urged

The housewife who is planning to "go over" her kitchen this Summer on a limited budget should remember that if she plans wisely and buys carefully, all the efficiency and practically all of the beauty obtainable in the most expensive installations are within reach.

Modern basic appliances, refrigerator, sink, and range, are available in a wide variety of styles and colors. The new "low cost" line of "low cost" features.

Efficient design and sound sturdy construction are the more important considerations, according to the Federal Housing Administration.

Cabinets and counters are available in a wide variety of styles and colors. The new "low cost" line of "low cost" features.

It is important to note that many of the new "low cost" line of "low cost" features.